



MMP PS450W-12VDC
 AC-DC Power Supply
 88-264 VAC in → 12 VDC, 37.5 Amps Out

The MMP-PS series of cased switching power supplies offers designers compact size, lightweight, low cost, and high reliability.

SPECIFICATION	VALUE
INPUT	
Input Voltage Range	90~132 VAC or 180~264 VAC via switch
Input Filter	N/A
Remote ON/OFF	N/A
OUTPUT	
Output Current	37.5 Amps DC
Voltage Accuracy	12V = ±1%
Output Adjustability	10.8 ~ 13.5V
Line Regulation (HL-LL)	±0.3%
Load Regulation (20-100% load)	±0.5%
Protections	Short circuit/Overload/Over voltage/Over temperature
Ripple/Noise (max.)	200mV p-p
Setup, Rise time	1500ms, 50ms /230 VAC 1500ms, 50ms /115 VAC @ full load
Hold time (Typical)	16ms/230VAC 12ms/115VAC @ full load
GENERAL	
Efficiency	83 %
Withstand Voltage (input to output)	I/P-O/P:3KVAC I/P-FG:1.5KVAC O/P-FG:0.5KVAC
Isolation Resistance (input to output)	I/P-O/P, I/P-FG, O/P-FG:100M Ohms / 500VDC / 25°C / 70% RH
Frequency Range	47 ~ 63Hz
ENVIRONMENTAL	
Working Temp.	-10°C to +60°C
Storage Temperature	-40°C to +85°C
Humidity (non-condensing)	20% to 90% RH
Cooling	Forced air fan built-in
PHYSICAL	
Dimensions	225 x 124 x 50mm (L*W*H)
Weight	2.5 lbs

MIDWEST MOTION PRODUCTS

DESIGN, MANUFACTURING & DISTRIBUTION - MOTION CONTROL EQUIPMENT

www.midwestmotion.com email: sales@midwestmotion.com

NOTES

1. All parameters NOT specially mentioned are measured at 230VAC input, rated load and 25 of ambient temperature.
2. Ripple & noise are measured at 20MHz of bandwidth by using a 12" twisted pair-wire terminated with a 0.1uf & 47uf parallel capacitor.
3. Tolerance : includes set up tolerance, line regulation and load regulation.
4. Power supply is a component to be installed into final equipment. Final equipment must be re-confirmed that it meets EMC directives.
5. De-rating may be needed under low input voltages. Please check the de-rating curve for more details.
6. Length of set up time is measured at first cold start. Turning ON/OFF the power supply may lead to increase of the set up time.
7. User should make sure the AC Input voltage matches the 120/240 VAC switch setting located on the side of the power supply.

Dimensional Drawing:

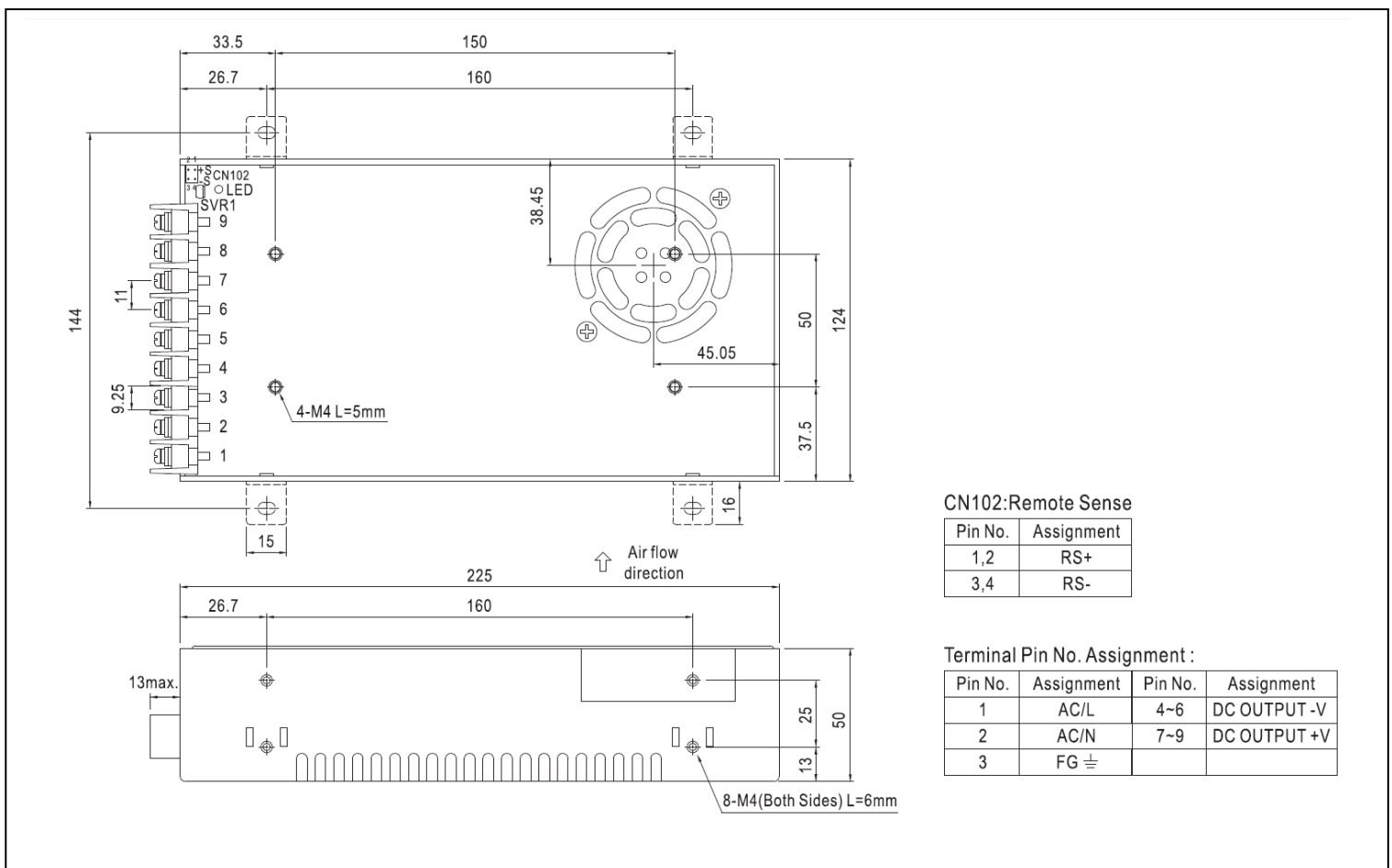

CN102:Remote Sense

Pin No.	Assignment
1,2	RS+
3,4	RS-

Terminal Pin No. Assignment :

Pin No.	Assignment	Pin No.	Assignment
1	AC/L	4-6	DC OUTPUT -V
2	AC/N	7-9	DC OUTPUT +V
3	FG \perp		